

Dual or Single Systems adapt to changing methodologies

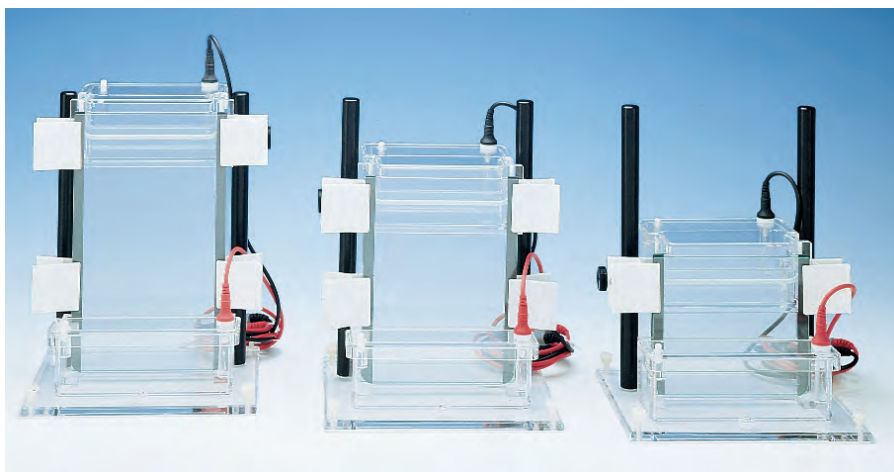
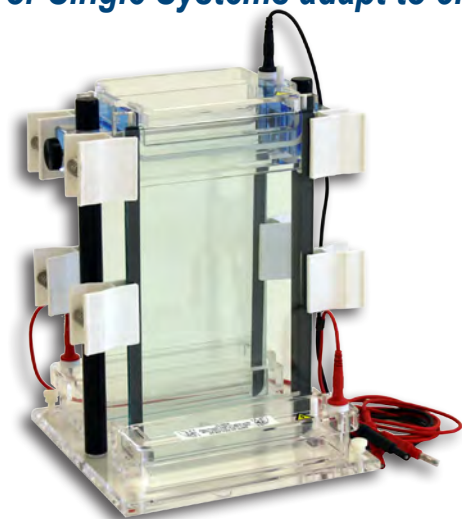

DUAL ADJUSTABLE VERTICAL SYSTEM

DASG-250, DASG-250-02, DASG-400, DASG-400-02

Complete System:

- Dual vertical electrophoresis cell with delrin rods, leveling base and bubble level
- Interlocking safety covers and power leads
- Leak proof silicone gasket on upper reservoir to which the glass plates are clamped
- Platinum electrodes
- 2 combs
- 2 sets glass plates
- 2 sets of Gel Wrap™ spacers
- 2 Gel Wrap™ Gaskets for gel casting
- 2 wedge plate separators
- White spring clamps

ADJUSTABLE VERTICAL SYSTEM

ASG-250, ASG-250-02, ASG-400, ASG-400-02

Complete System:

- Single vertical electrophoresis cell with delrin rods, interlocking safety covers, power leads, and leveling base with bubble level
- Leak proof silicone gasket on upper reservoir to which the glass plates are clamped
- Platinum electrodes
- 2 combs
- 2 sets glass plates
- 2 sets of Gel Wrap™ spacers
- 2 Gel Wrap™ Gaskets for gel casting
- 1 wedge plate separator
- White spring clamps

FEATURES

- Single and Dual Adjustable Slab Gel Systems are designed to meet a variety of applications.
- The adjustable upper buffer reservoir rides on two delrin rods, and is secured in place by two stainless steel hand screws, providing the flexibility of running 16.5cm wide gels in lengths from 145mm up to 280mm (ASG-250 or DASG-250) or from 145mm up to 387mm (ASG-400 or DASG-400).
- The Dual Adjustable Slab Gel System allows two gels to be run simultaneously under identical buffer conditions.
- A CE/EU version of safety cover is available for both the single and dual adjustable units (not shown). To specify the CE version order the Adjustable Units with "-02" at the end of the catalog number.
- 16.5cm wide glass plates are available from two different materials and in seven lengths: 145mm, 160mm, 170mm, 190mm, 220mm, 280mm, and 387mm, and can be ordered with front plate beveled for two-dimensional electrophoresis.
- Spacer sets are offered in thicknesses of 0.75mm, 1.0mm, 1.5mm and 2.0mm. For full listing of accessories please consult our website or product list.

APPLICATIONS

- SDS PAGE/Native PAGE
- Mobility Shift Assays
- DNA Fingerprinting
- Differential Display
- Nucleic Acid Sequencing
- DNA Paternity Testing
- DNA Fingerprinting
- DNA Footprinting

SPECIFICATIONS		
Cat. #	DASG-250 DASG-250-02 ASG-250 ASG-250-02	DASG-400 DASG-400-02 ASG-400 ASG-400-02
Glass plate dimension options (cm)	16.5(w) x 14.5(l) 16.5(w) x 16 (l) 16.5(w) x 17 (l) 16.5(w) x 19(l) 16.5(w) x 22(l)	16.5(w) x 14.5(l) 16.5(w) x 16(l) 16.5(w) x 17(l) 16.5(w) x 19(l) 16.5(w) x 22(l) 16.5(w) x 28(l) 16.5(w) x 38.7(l)
overall dimensions (cm)	22(w) x 19(l) x 22(h)	22(w) x 19(l) x 42(h)

GEL CASTING OPTIONS

Option #1: The Gel Wrap™ Casting System: C.B.S. Scientific has developed a revolutionary leak-proof gasket, Gel Wrap, that seals the glass plate sandwich for gel casting quickly and easily. Set-up time for gel casting can be accomplished in less than one minute. Gel Wrap is designed to perform two functions simultaneously - it holds onto the back glass plate, making it easy to handle, and it seals the spacers.

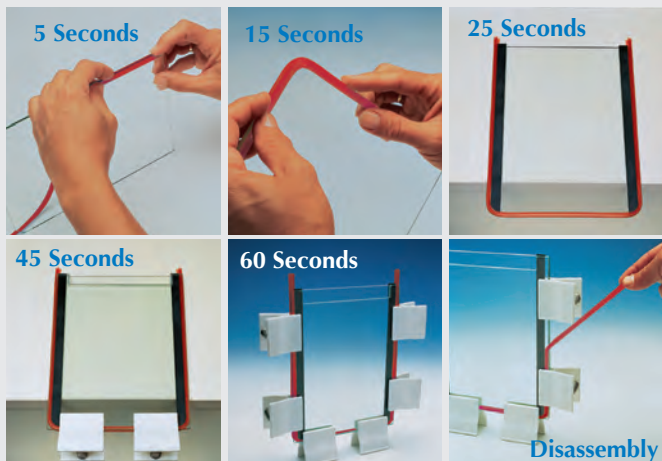

Option # 2: Multiple Gel Casting Chamber Kits:



Both the GCC-404K (4-place) and the GCC-410K (10-place) Casting Chambers fit all 16.5cm wide glass plates with heights up to 22cm. Each kit includes:

- Multi-Caster Chamber with lid, silicone gasket, stainless steel clamps, backfill port connecting to central filling trough
- 4 (4-place) or 10 (10-place) notched glass plate sets, spacers, and combs
- Polycarbonate separation sheets
- Acrylic shim plate

4-place Multiple Gel Casting Chamber GCC-404-K, diagram shown below depicts proper assembly for gel casting.

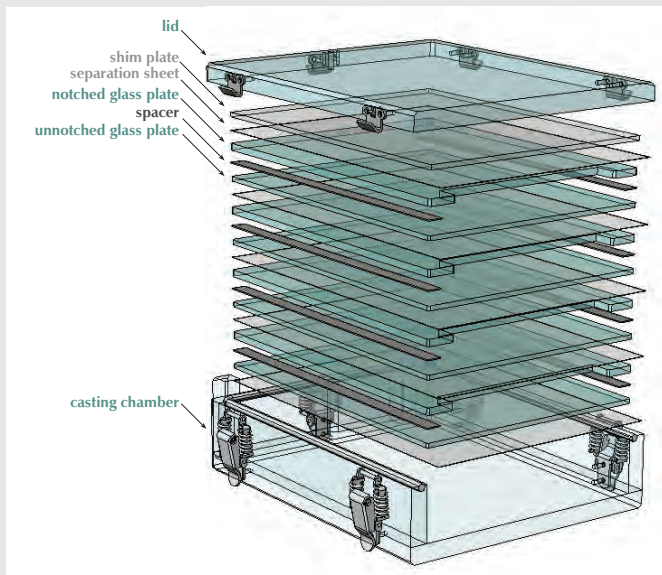

COMB OPTIONS for 16.5 cm wide units
overall length = 13.1 cm

Cat. #	tooth depth (mm)	# of teeth	thickness of teeth	width of teeth	maximum well volume (µl)
VGC-0710	19.1	10	0.75	10.1	145
VGC-0712	19.1	12	0.75	7.9	113
VGC-0714	19.1	14	0.75	6.4	91
VGC-0715	19.1	15	0.75	5.7	82
VGC-0716	19.1	16	0.75	5.2	74
VGC-0720	17.7	20	0.75	4.2	56
VGC-0729	17.7	29	0.75	2.9	38
VGC-0730	17.7	30	0.75	2.8	37
VGC-1010	19.1	10	1.0	10.1	194
VGC-1012	19.1	12	1.0	7.9	151
VGC-1014	19.1	14	1.0	6.4	121
VGC-1015	19.1	15	1.0	5.7	109
VGC-1016	19.1	16	1.0	5.2	98
VGC-1020	19.1	20	1.0	4.2	74
VGC-1029	17.7	29	1.0	2.9	51
VGC-1030	17.7	30	1.0	2.8	49
VGC-1510	17.7	10	1.5	10.1	291
VGC-1512	19.1	12	1.5	7.9	227
VGC-1514	19.1	14	1.5	6.4	182
VGC-1515	19.1	15	1.5	5.7	163
VGC-1516	19.1	16	1.5	5.2	147
VGC-1520	17.7	20	1.5	4.2	111
VGC-1529	17.7	29	1.5	2.9	77
VGC-1530	17.7	30	1.5	2.8	74

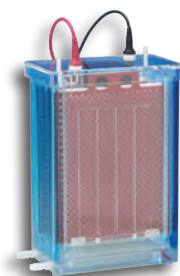

Compatible Blotting Chamber

This System, cat. # EBU-102, provides the capability of transferring 3 gels simultaneously under identical temperature controlled buffer conditions. Temperature control is achieved by passing coolant through the base of the blotter. This vertical blotting system can accommodate gels of dimensions up to 16cm(w) x 21.5cm(h).

ORDERING INFORMATION *

ADJUSTABLE VERTICAL SLAB GEL SYSTEMS - 16.5C WIDE

CAT. #	ITEM
ASG-250	Adjustable Slab Gel Kit, Adjusts from 145mm-280mm.
ASG-250-02	Adjustable Slab Gel Kit, CE. Adjusts from 145mm-280mm.
ASG-400	Adjustable Slab Gel Kit. Adjusts from 145mm-400mm.
ASG-400-02	Adjustable Slab Gel Kit, CE. Adjusts from 145mm-400mm.
DASG-250	Dual Adjustable Slab Gel Kit. Adjusts from 145mm-280mm.
DASG-250-02	Dual Adjustable Slab Gel Kit, CE. Adjusts from 145mm-280mm.
DASG-400	Dual Adjustable Slab Gel Kit. Adjusts from 145mm-400mm.
DASG-400-02	Dual Adjustable Slab Gel Kit, CE. Adjusts from 145mm-400mm.
GCC-404K*	Multiple Gel Casting Chamber Kit, 4-place Fits glass plates 16.5cm(w) up to 22cm(h).
GCC-410K*	Multiple Gel Casting Chamber Kit, 10 place Fits glass plates 16.5cm(w) up to 22cm(h).
EBU-102	Electrophoretic Blotting Chamber, 3 place, CE Includes 1 cassette.
EBC-102	Additional Electrophoretic Blotting Cassette.

* See Product List or website for complete listing of catalog numbers and ordering options